



**10 Old Road, , Ammanford, SA18 2ED**

**Offers in the region of £220,000**

A character semi detached house set in a popular location on the edge of Ammanford town centre close to its range of schools, shopping and transport facilities. Accommodation comprises porch, entrance hall, lounge, sitting room, kitchen, 3 bedrooms and bathroom. The property benefits from off road parking, garage, uPVC double glazing, gas central heating and enclosed rear garden.



## Ground Floor

### Porch

5'2" x 7'11" (1.58 x 2.43 )

with uPVC double glazed frosted windows and stained glass window to side

### Entrance Hall

5'8" x 7'9" (1.74 x 2.37)

with original Victorian style floor tiles, stairs to first floor and radiator

### Lounge

12'7" x 11'10" (3.86 x 3.63 )



with electric fire in feature surround, radiator, coved ceiling and uPVC bay window to front

### Sitting Room

13'4" x 12'9" (4.07 x 3.90)



with feature fireplace, radiator, coved ceiling, under the stairs cupboard and uPVC double glazed bay window to rear

## Kitchen

11'10" x 7'5" (3.61 x 2.27 )



with base and wall units, single bowl and single drainer sink unit with mixer taps, 4 ring gas hob with extractor over and oven under, plumbing for automatic small dishwasher, plumbing for automatic washing machine, space for under counter fridge freezer, part tiled walls, tiled floor, radiator, coved ceiling and uPVC double glazed window to rear and side and door to side.

## First Floor

### Landing

with hatch to roof space and coved ceiling

### Bedroom 1

13'6" x 11'10" (4.14 x 3.63 )



with radiator, coved ceiling and uPVC double glazed bay window to front

## Bedroom 2

12'3" x 7'11" (3.74 x 2.43 )



with radiator, textured and coved ceiling and uPVC double glazed window to rear

## Bedroom 3

9'2" x 11'4" (2.80 x 3.46 )



with radiator, coved ceiling, built in wardrobe and uPVC double glazed window to rear

## Bathroom

5'3" x 8'4" (1.62 x 2.55 )



with low level flush WC, pedestal wash hand basin, panelled bath with mains shower over and glass screen, part tiled walls, tiled floor, shaver point, radiator, textured and coved ceiling and uPVC double glazed window to side

## Outside



with off road parking and garage to side, side access to rear lawned garden and brick built shed

## Services

Mains gas, electric, water and drainage

## Council Tax

Band D

## NOTE

All internal photographs are taken with a wide angle lens.

## Directions

Leave Ammanford on College Street and travel for approximately one mile to the Green in Bonllwyn, turn right at the start of

the green and the property can be located  
on the right hand side.



GROUND FLOOR  
526 sq.ft. (48.8 sq.m.) approx.

1ST FLOOR  
475 sq.ft. (44.1 sq.m.) approx.

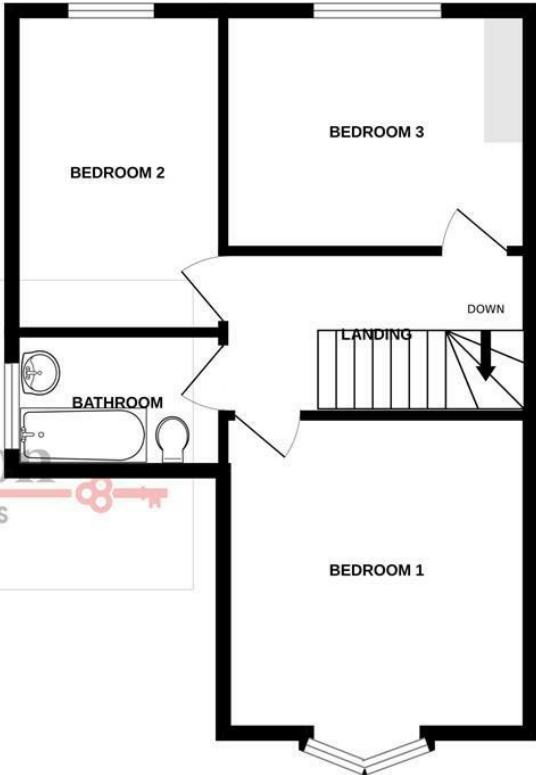
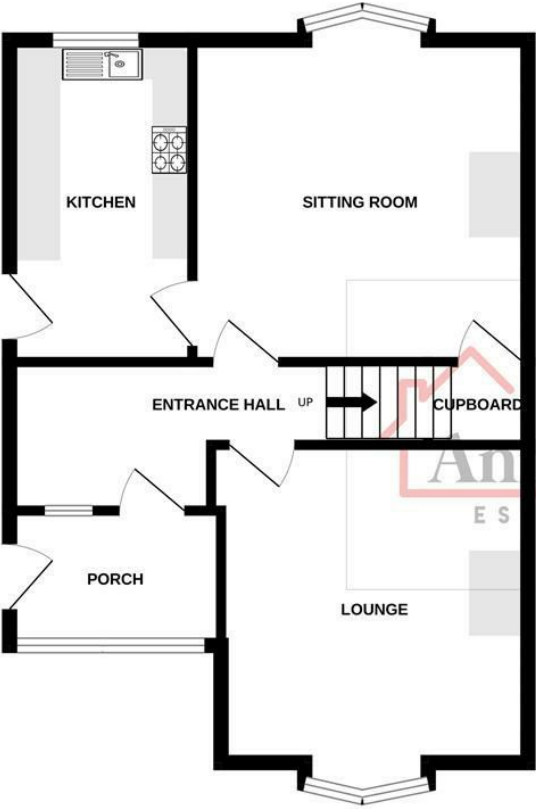

TOTAL FLOOR AREA : 1001 sq.ft. (93.0 sq.m.) approx.

Whilst every attempt has been made to ensure the accuracy of the floorplan contained here, measurements of doors, windows, rooms and any other items are approximate and no responsibility is taken for any error, omission or mis-statement. This plan is for illustrative purposes only and should be used as such by any prospective purchaser. The services, systems and appliances shown have not been tested and no guarantee as to their operability or efficiency can be given.  
Made with Metropix ©2026

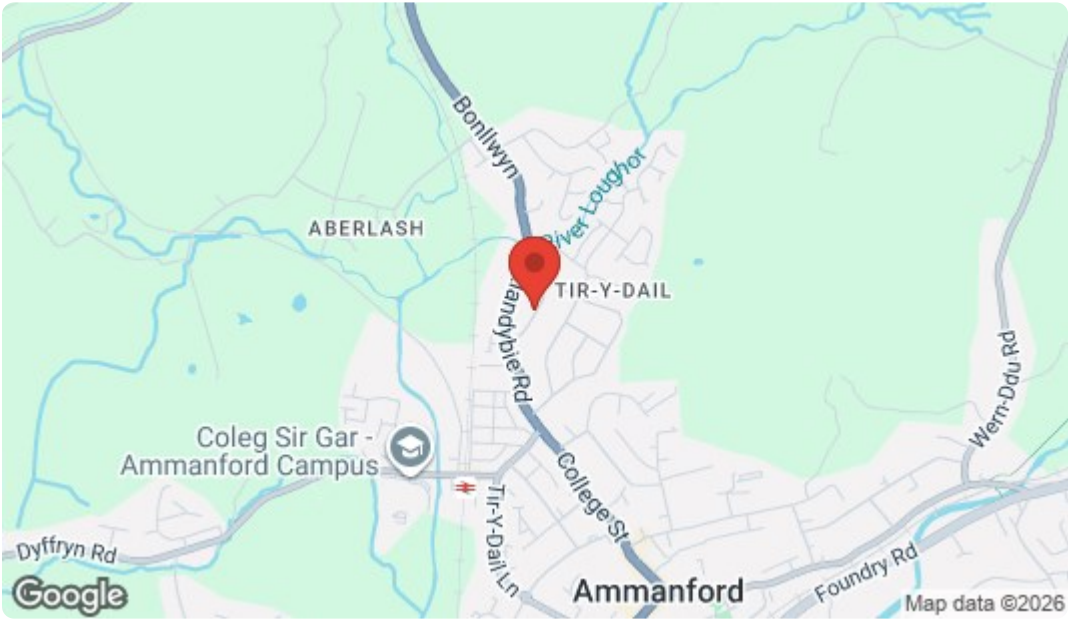

Energy Efficiency Rating		
	Current	Potential
Very energy efficient - lower running costs		
(92 plus) A		
(81-91) B		
(69-80) C		
(55-68) D		
(39-54) E		
(21-38) F		
(1-20) G		
Not energy efficient - higher running costs		
England & Wales		EU Directive 2002/91/EC
Environmental Impact (CO <sub>2</sub> ) Rating		
	Current	Potential
Very environmentally friendly - lower CO <sub>2</sub> emissions		
(92 plus) A		
(81-91) B		
(69-80) C		
(55-68) D		
(39-54) E		
(21-38) F		
(1-20) G		
Not environmentally friendly - higher CO <sub>2</sub> emissions		
England & Wales		EU Directive 2002/91/EC

Please note:  
We have not tested any services, equipment or facilities. Purchasers must satisfy themselves by inspection or otherwise.